

The use or communication of the contents there of are forbidden without express authority. (당사의 사전 허락없이 무단 전제 및 복사를 금함)

NO	REVISION RECORD	DATE	CHK.	APPR.

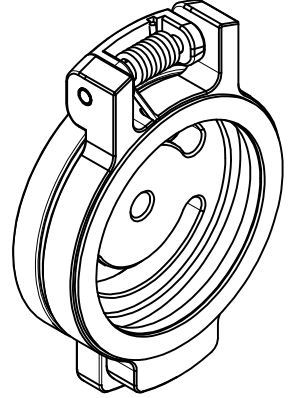
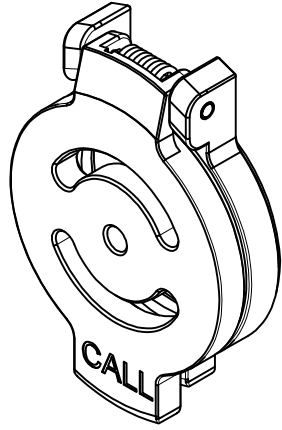
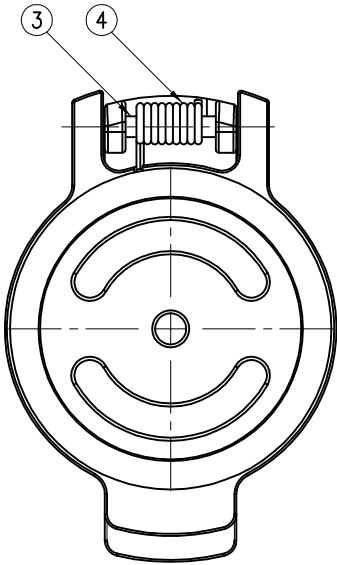
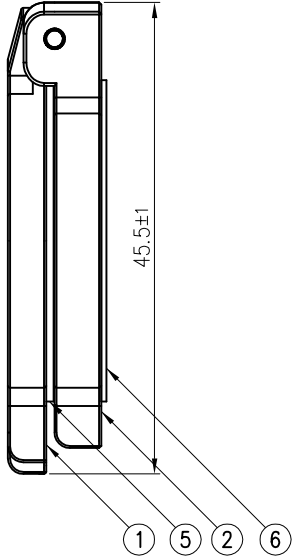
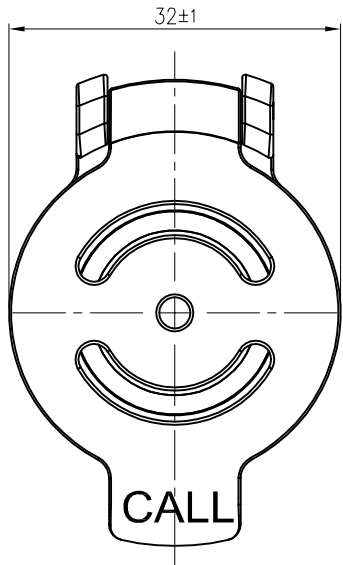
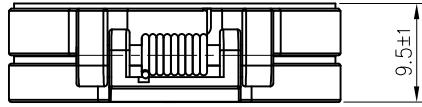

TOLERANCE(mm) (KS B 0412에 준함)	
6 이하	±0.05
6 ~ 30	±0.1
30 ~ 120	±0.15
120 ~ 315	±0.2
300 ~ 1000	±0.3
1000 ~ 2000	±0.5

Note
 1. 특징 :
 2. 용도 :

6	S/W COVER/PAD_A	PTRA-CP01-X006	1	SILICON(0.5t)
5	S/W COVER/PAD_A	PTRA-CP01-X005	1	SILICON(1.0t)
4	S/W COVER/SPRING	PTRA-CP01-X004	1	SUS304
3	S/W COVER/PIN	PTRA-CP01-X003	1	SUS304
2	S/W COVER/BASE	PTRA-CP01-X002	1	Zinc
1	S/W COVER/TOP	PTRA-CP01-X001	1	Zinc

FINISH	MATERIAL	UNIT	mm	NO.	DESCRIPTION	DWG. NO	QTY	REMARK
도금 : 샌딩/베로아 도장 : -	Zinc Casting	APP. DWG.	2022.01.10		DWG. NO. PART NAME			V1.0
QTY	Hardware			1/1	ASS'Y NAME	BUTTON COVER ASS'Y		
1 EA/SET	A3				MODEL NO.	CH-083		